

0 5 10 20m

general notes:  
 all dimensions shall be checked on site prior to commencing works.  
 all works shall conform to the current edition of the building regulations and other relevant statutory requirements.  
 all materials and workmanship shall conform with the relevant british standard specifications and codes of practice.  
 this drawing is the copyright of gdm architects and shall not be copied or reproduced without permission.  
 this drawing shall be read in conjunction with gdm architect's health and safety risk assessments and all works shall be carried out in a safe manner, by competent persons.  
 drawing produced by gdm architects ltd trading as gdm architects.

revision: details: by: date:  
 p1 first issue tw 17.10.25  
 a planning issue tw 22.10.25  
 b title block updated TW 19.11.25



street scene a-a  
 Scale 1:200 @ A1



street scene b-b  
 Scale 1:200 @ A1

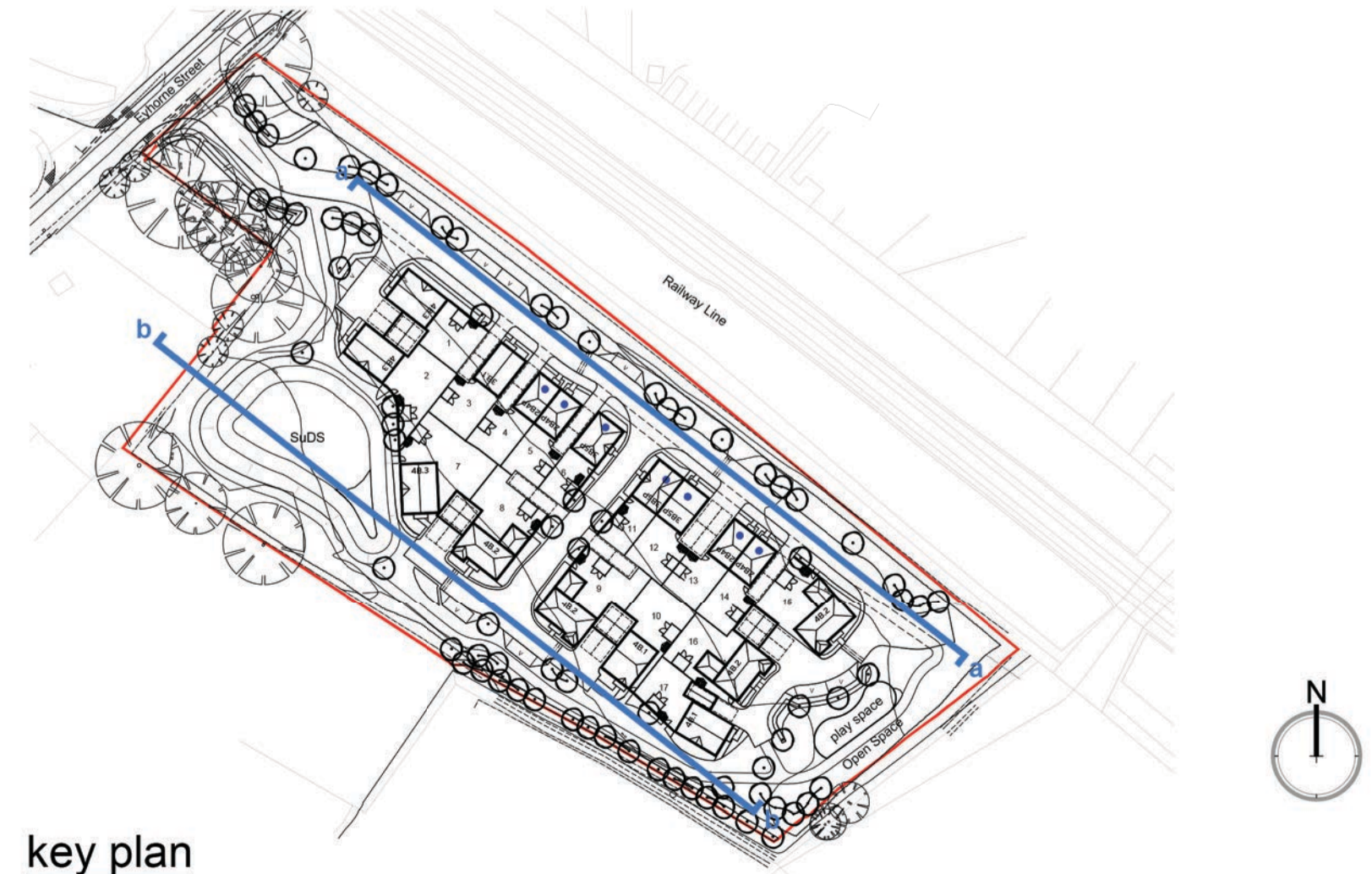

**gdmarchitects**

the master's house, college road, maidstone, kent ME15 4YF  
 t: 01622 766670 e: info@gdmarchitects.co.uk w: gdmarchitects.co.uk

client: Cantium land & Development

project: Eyhorne Street, Hollingbourne

title: proposed street scenes  
 a-a & b-b

date: october 2025 drawn by: tw

scale: 1:200@a1 checked: gve

**PLANNING**

project number	drawing number	revision
4500	p200	b