

COPY

KENT COUNTY AGRICULTURAL EXECUTIVE COMMITTEE.

TILE DRAINAGE SCHEME ON LAND AT LOWER WALL, BURMARSH.

ROMNEY MARSH FARMS LTD.

SCHEME No T1195

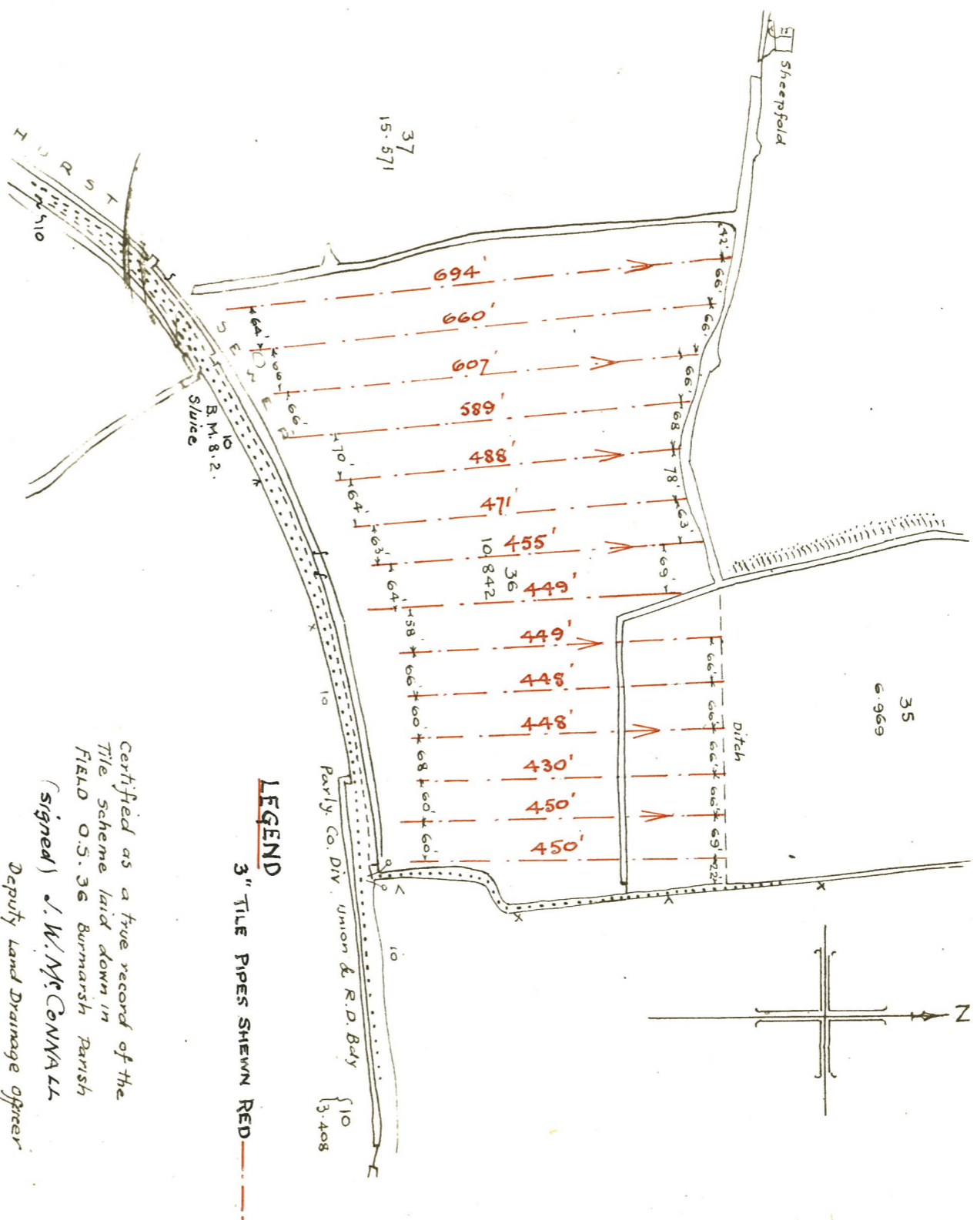

LEGEND
3" TILE PIPES SHOWN RED

Certified as a true record of the
Tile Scheme laid down in
FIELD O.S. 36 Burmarsh Parish
(signed) J. W. McCONNALL
Deputy Land Drainage Officer
Based upon Ordnance Survey Map.

Mustard's field

K S LXXIII - 16 (1907)