

Windmill Manor, Bowl Road, Charing

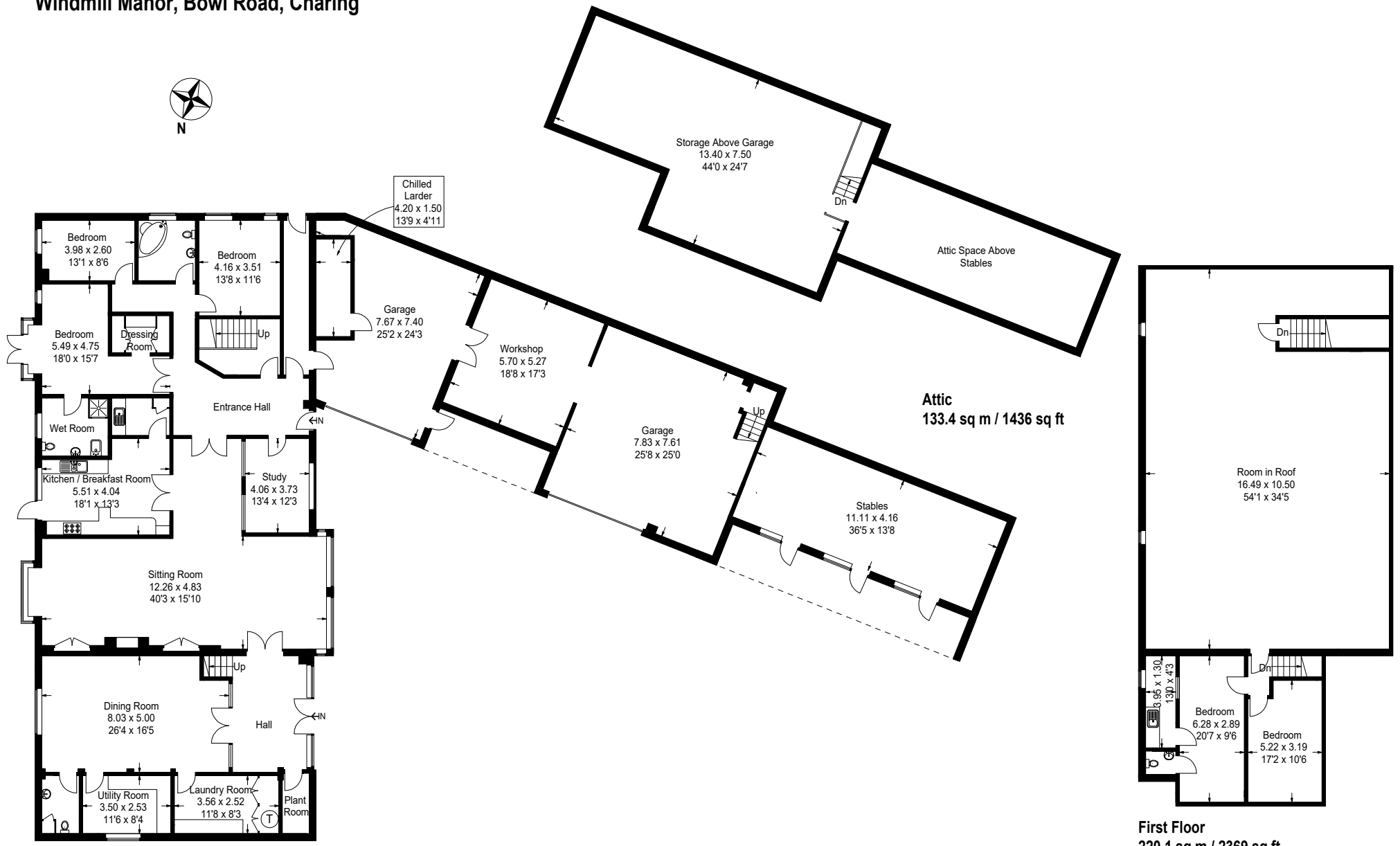

Ground Floor
 387.1 sq m / 4167 sq ft

First Floor
 220.1 sq m / 2369 sq ft

Approximate Gross Internal Area = 740.6 sq m / 7972 sq ft
 Garage = 108.2 sq m / 1165 sq ft
 Total = 848.8 sq m / 9137 sq ft

This plan is for layout guidance only. Not drawn to scale unless stated. Windows and door openings are approximate. Whilst every care is taken in the preparation of this plan, please check all dimensions, shapes and compass bearings before making any decisions reliant upon them. (ID431444)